

# Inground 1-11

Cat. No. IG111

Cat. No. IG111MH20

Cat. No. IG111MH35

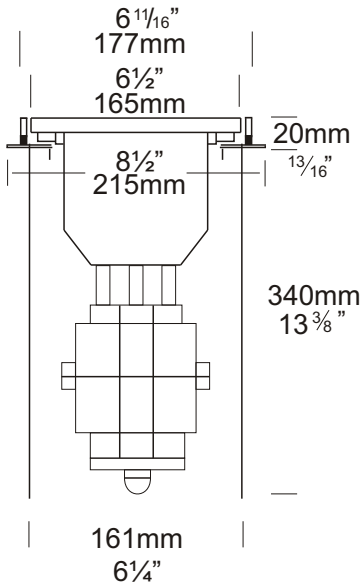

The Inground 1-11 is suitable for use with 60 watt IRC lamps, which have a range of beam angles from 8 to 45 degrees and is complete with its own 120 or 240 volt ac integral power supply and thermal overload. The AR1-11 lamp has very low glare output due to the dome covering the halogen capsule. The luminaire can be driven over at 10km/h max (6mph) with a maximum vehicle weight of 1500kg (3000lbs) or walked upon without being damaged. The fixture also has a 'Flush Fit' lens which stops water pooling and depositing dirt on the lens.

The Inground 1-11 is supplied with a mounting canister. The lamp can be directed (up to 20 degrees) without the need to remove the fitting from the canister due to the vandal-resistant four allen head screw fixing system which attaches the flange to the body of the luminaire.

The Inground 1-11 Metal Halide is extremely energy efficient, outputting 2-3 times the light of a halogen lamp, and uses a GX10 20 or 35 watt lamp.

Inground 1-11



Inground Metal Halide



## Ordering Information

**Luminaire Type**

**Flange Option**

**Body**

**Accessories**

IG1-11 - Inground 1-11

SBZ - Solid Bronze Black only  
SS - 316 Stainless Steel

CJK150 - Cable Joint Kit  
LENSAR111F - Frosted Lens  
LENSSPREAD - Spread Lens  
MH - Metal Halide Option

For LED options, refer to page 10.4.3 (6 watt) or 10.4.4 (3 watt) or <http://hunza.co.nz/l.html>

Ordering Example: IG111 SBZ - Inground 1-11 with Solid Bronze flange

IG111MH20 SBZ - Inground 1-11 Metal Halide 20 watt with Solid Bronze flange

LENSAR111F - Frosted Lens  
(Accessories ordered separately)

**HUNZA**™ PURE OUTDOOR LIGHTING

**HUNZA FACTORY**  
130 Felton Mathew Ave  
Glen Innes  
Auckland 1072  
New Zealand

Ph: 64-9-528 9471  
Fax: 64-9-528 9361  
[hunza@hunza.co.nz](mailto:hunza@hunza.co.nz)  
[www.hunza.co.nz](http://www.hunza.co.nz)

**INTERNATIONAL CONTACTS:**  
[www.hunza.co.nz/contacts.php](http://www.hunza.co.nz/contacts.php)

Specifications may change without notice.  
Manufactured in New Zealand.  
© 2011 Hunza Holdings Ltd.

Ver 1.4

## Luminaire Construction

### Body

Cast from virgin high corrosion resistant CC401 low copper aluminium alloy, with chromate substrate and high UV resistant black polyester powder coat.

### Flanges

The flange is attached to the body by four 316 stainless steel allen head anti vandal screws and is available in either

Solid bronze - 170mm (6½") bar.

Solid 316 Stainless Steel - 170mm (6½") bar rod.

### Mounting

The Inground 1-11 supplied with a mounting canister for casting in concrete. The fitting can be driven over or walked upon without damaging it. Maximum drive over speed 10 km/h (6 mph) and maximum vehicle weight 1500kg (3300lbs).

## Features

### Lens:

12mm (½") thick 'Flush Fit' clear tempered shatter resistant glass.

### Lifetime Warranty.

### Beam Angles:

8°, 24° and 45°

### Gasket:

Silicone, iron impregnated 220°C (428°F).

### Lamp Holder:

GU53: Lamp cradle can be rotated 360° and angled up to 20°.

### Accessories:

Cable Joint Kit (Cat. CJK150).

Frosted Lens (Cat. LENSAR111F).

Linear Spread Lens (Cat. LENS.SPREAD).

Metal Halide Option (Cat. MH).

## Standards

IP66



UL1598

### Luminaire Weight

4.8kgs (10lbs 8oz)

### Power Supply

HUNZA™ built in transformer.

Input: voltage 240 volt ac 50Hz.

Metal Halide - 230-240 volt ac 50Hz built in ballast

USA and Canada:

Input voltage: 120 volt ac 60 Hz.

Metal Halide - 120 volt ac 60Hz built in ballast

### Luminaire: supplied with

GU53 - 60 watt IRC lamp max.

**LED** - Refer to previous page.

Metal Halide - GX10 20 or 35 watt lamp

## Metal Halide Lamp Beam Angles

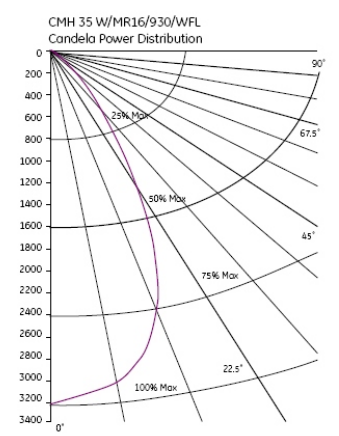
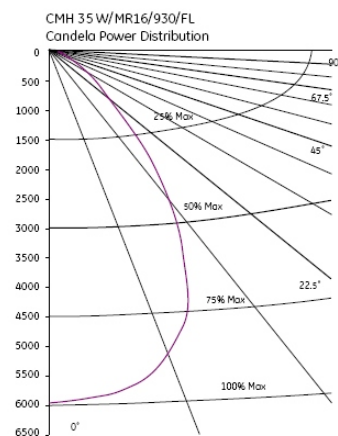
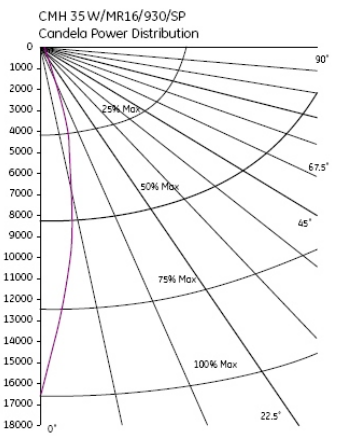
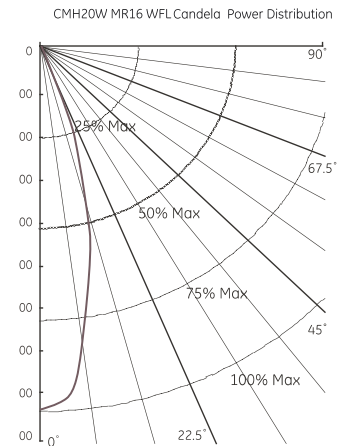
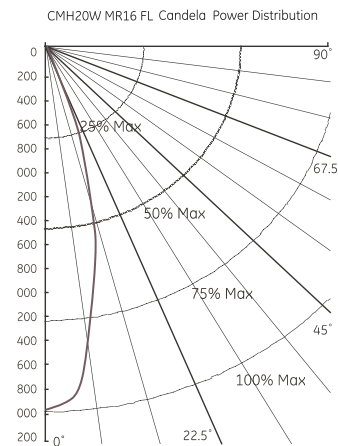
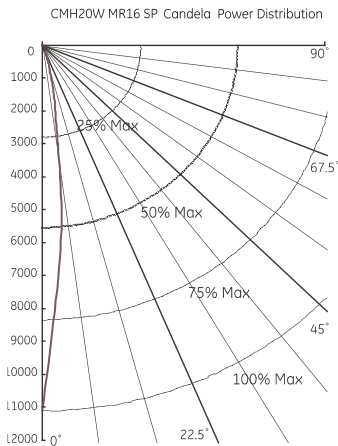

**HUNZA**™ PURE OUTDOOR LIGHTING

HUNZA FACTORY  
130 Felton Mathew Ave  
Glen Innes  
Auckland 1072  
New Zealand

Ph: 64-9-528 9471  
Fax: 64-9-528 9361  
hunza@hunza.co.nz  
www.hunza.co.nz

INTERNATIONAL CONTACTS:  
[www.hunza.co.nz/contacts.php](http://www.hunza.co.nz/contacts.php)

Specifications may change without notice.  
Manufactured in New Zealand.  
© 2011 Hunza Holdings Ltd.

Ver 1.4