

# Step Lite Solid Eyelid Square

Cat. No. SLSSQ  
Cat. No. SLSSQGU

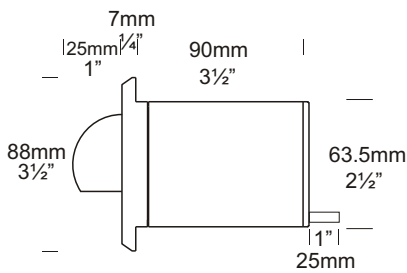
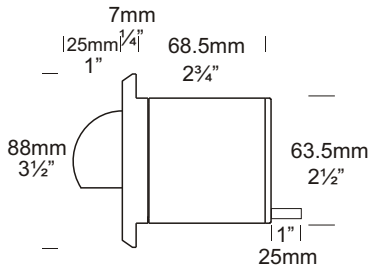

The Square Solid Eyelid Step Lite has an 88mm x 88mm (3 1/2" x 3 1/2") flange. It has a smooth machine finish without mounting holes to disrupt the elegant line of the fitting and is designed to fit into a mounting canister. The eyelid masks two thirds of the lamp which eliminates all upward light.

A GU10 version of this luminaire is also available for line voltage lamps. However, a longer luminaire body is needed to accommodate the longer lamp.

## Ordering Information

Luminaire Type	Material/Finish	Accessories
SLSSQ - Step Lite Solid Eyelid Square	BK - Black	CJK150 - Cable Joint Kit
	BZ - Bronze	LENSSTEPF - Frosted Lens
	GN - Green	HCL - Hex Cell Louvre Adaptor
	STAR - Silver Star	Canss - 316 Stainless Steel Canister
	WH - White	Sican - Step Lite Canister
	WB - Birch	GU - GU10 Option
	DG - Dark Grey	
	OG - Olive Green	
	RG - Beige	
	PR - Primrose	
COP - Copper		
SS - 316 Stainless Steel		

Ordering Example: SLSSQ COP - Step Lite Solid Eyelid Square in Copper

SLSSQGU BK - Step Lite Solid Eyelid Square GU10 in Black

HCL COP - Hex Cell Louvre Adaptor in Copper  
(Accessories ordered separately)



## Luminaire Construction

CNC machined from one of the following metals:

High corrosion resistant 63.5mm (2½") x 10mm (25/64") aluminium.  
End cap - solid aluminium 63.5mm (2½") rod, flange 90mm x 90mm (3½" x 3½") solid aluminium bar with chromate substrate and high UV resistant polyester powder coat

**Colours** Black, Bronze, Green, Silver Star, White, Birch, Dark Green, Olive Green, Beige, Primrose.

**Copper:** 63.5mm (2½") x 10mm (13/32"). End cap - solid copper 63.5mm (2½") rod.

Flange 90mm x 90mm (3½" x 3½") solid copper bar.

**316 Stainless steel:** 9mm (11/32"). End cap - solid 316 stainless steel 63.5mm (2½") rod.

Flange 90mm x 90mm (3½" x 3½") solid 316 stainless steel bar.

## Mounting

Designed to fit through a 66mm (2 5/8") hole and be fixed into position by two screws in the flange or a Step Lite canister (see accessories) can be used which maintains the aesthetic look of the flange by eliminating the two screw holes in the flange.

## Features

**Lens:**  
3mm (1/8") thick clear tempered shatter resistant glass.

Lifetime Warranty.

**Gaskets:**  
Silicone, iron impregnated 220°C (428°F).

**Lamp Holders:**  
GU5.3 & GU10 - 350°C (662°F) ceramic multi contact lamp holder with 250°C (480°F) teflon cables.

## Accessories:

Cable Joint Kit (Cat. CJK150)  
Not approved for USA/Canada.

Frosted Lens (Cat. LENSSTEPF).  
Hex Cell Louvre Adaptor (Cat. HCL).  
Step Canister (Cat. Sican).

316 Stainless Canister for use in lime stone etc. (Cat. Canss).  
GU10 Option (Cat. GU).

## Standards

EN60598

IP66/IP68



UL1838

## Luminaire Weight

12 volt

Alum .465kg (1lb)

Cop 1.340kg (2lb 15oz)

SS 1.055kg (2lb 5oz)

## Power Supply

HUNZA™ Inground or Wall Mount

Transformer: not included.

USA and Canada:

HUNZA™ Wall Mount Transformer:  
not included.

**Luminaire: supplied with Halogen**

MR16 GU5.3 20 watt lamp max.  
lamp.

GU10 - GU10 25 or 35 watt lamp max.

USA and Canada:

MR16 GU5.3 20 watt lamp max.

GU10 Halogen - Lamp not supplied

Step Lite Solid Eyelid Square MR16 BAB 20 watt lamp - Lens height 400mm (15¾")

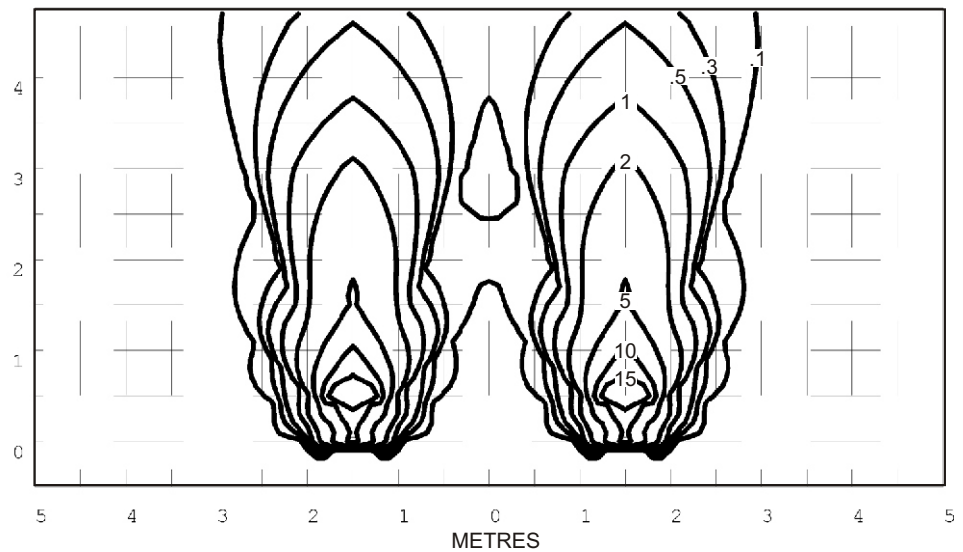
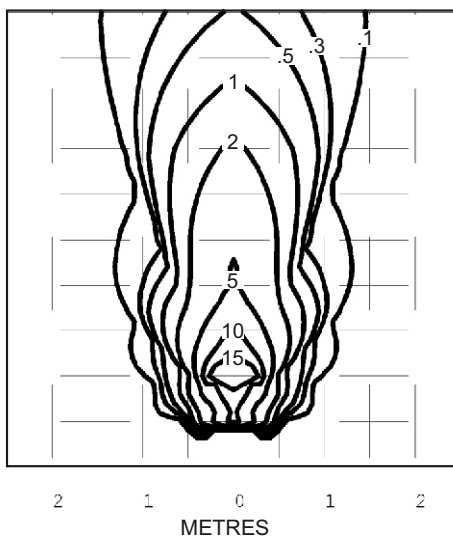

Isolux Lumens Plot - Footcandles = Isolux figures divided by 10.76

**HUNZA™** PURE  
OUTDOOR  
LIGHTING

**HUNZA FACTORY**  
130 Felton Mathew Ave  
Glen Innes  
Auckland 1072  
New Zealand

Ph: 64-9-528 9471  
Fax: 64-9-528 9361  
hunza@hunza.co.nz  
www.hunza.co.nz

**INTERNATIONAL CONTACTS:**  
www.hunza.co.nz/contacts.php

Specifications may change without notice.  
Manufactured in New Zealand.  
© 2011 Hunza Holdings Ltd.

Ver 1.4