

Washer PURE LED

PROJECT:

TYPE:

SOURCE:

NOTES:

SPECIFICATIONS

IK10 IP68   Pending

LED Chip	Cree CXA 1304 field replaceable LED board
Luminaire Output	600 Lumens @ 1050mA (9 watts), Delivered from Luminaire with unobstructed beam.
Lumens Per Watt	66 Lumens minimum @ 9 watts, Delivered from Luminaire with unobstructed beam
CRI (3000K)	80 Standard, 90+ Optional
Colour Temperatures	2700K, 3000K, 4000K
Beam Angles	Asymmetric Wash
Ingress Protection	IP68
Inverse Kinematics Rating	IK10
Maximum Load	2000kgs (4400lbs)
Warranty	Electronics = 5 years Body Cop/SS = 10 years Body Aluminium = 5 years
Standards	BS/EN 60598.2.2 cUL 1838, 2108 Pending CE

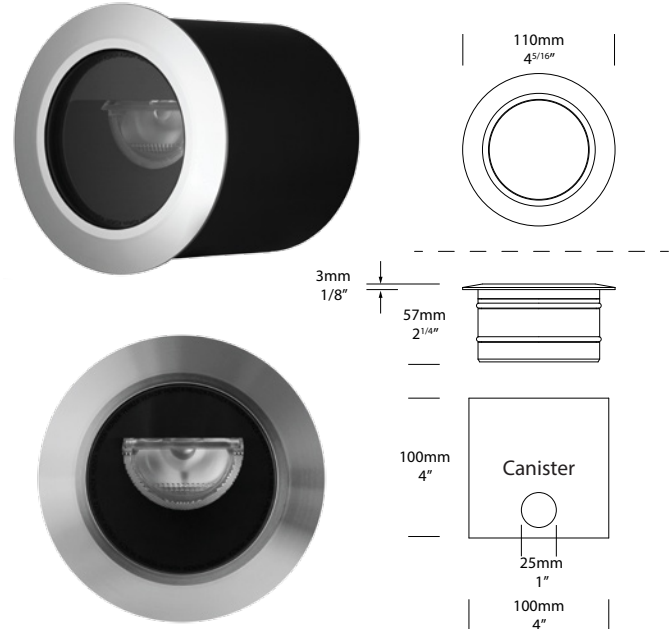

PRODUCT CONFIGURATION

Please fill in appropriate codes into boxes provided

Cat. No. WASH/L

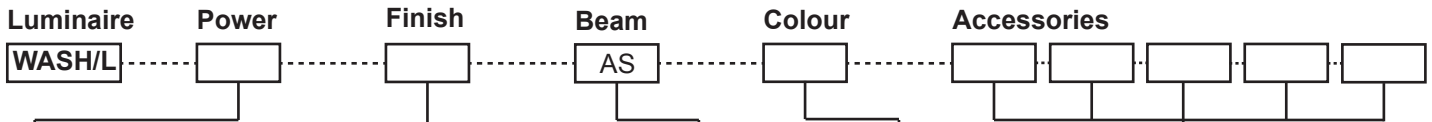

- S** SERIES, REMOTE DRIVER
- D3** 12VAC, 3W INTEGRAL
- D7** 12VAC, 6W INTEGRAL
- D10** 12VAC, 9W INTEGRAL

SERIES, REMOTE DRIVER REQUIRED:
Constant current driver
Individual fixtures require 9vdc @ 1050mA maximum

12VAC INTEGRAL DRIVER:
Transformer required
Hunza integrated plug and play driver
Input: 9-15VAC.
Output: 9vdc @ D3=350mA, D7=700mA, D10=1050mA (1050mA limited to ≤ 40°C (104°F) ambient temperature in Stainless Steel)

- ALUMINIUM**
- EBK** BLACK
 - EBZ** BRONZE
 - EOGR** OLIVE GREEN
 - EWH** WHITE
 - EWB** WHITE BIRCH
 - EDG** DARK GREY
 - ESTAR** SILVER STAR
 - ECT** CORTEN
- COP** SOLID COPPER
 - SS** STAINLESS STEEL

- AS** ASYMMETRIC
- 2** 2700K
- 3** 3000K
- 4** 4000K
- 39** 3000K, 90+ CRI

- LF** FROSTED LENS
- CJK** CABLE JOINT KIT
- CGS** CUSTOM GLARE SHIELD
Must be discussed with the factory

ADDITIONAL COMMENTS:

[Hunza Power Supply Selection Chart](#)
[Hunza Voltage Drop Chart](#)

LUMINAIRE CONSTRUCTION

CNC machined from one of the following metals:

Aluminium:

Body - High corrosion resistant 88.9mm (3 1/2") 6061 aluminium. Flange - solid aluminium 115mm (4 1/2") rod, Finished with chromate substrate, Epoxy layer and a UV resistant polyester powder coat colour.

Colours:

Black, Bronze, Silver Star, White, White Birch, Olive Green, Dark Grey, Corten.

Copper:

Body - 88.9mm (3 1/2"). Flange - solid copper 115mm (4 1/2") rod.

316 Stainless Steel:

Body - 88.9mm (3 1/2"). Flange - solid 316 stainless steel 115mm (4 1/2")

Step Lens:

10mm (25/64") Extra clear, low iron, shatter resistant glass. Lifetime warranty

Gaskets:

Silicone, iron impregnated 220°C (428°F)

Cable:

Water resistant rubber

Mounting:

The Washer comes with a PVC mounting canister for casting into the ground, vertical surface or into concrete.

Maximum drive over speed 10 kp/h (6mp/h) with a maximum load rating of 2000kgs (4400lbs).

Luminaire Weight:

Stainless Steel 1.5kg (3lbs 5oz)

Solid Copper 1.6kg (3lbs 8oz)

Aluminium 1kg (2lbs 3oz)

ACCESSORIES

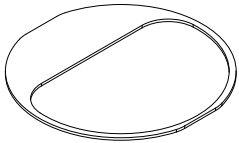

Custom Glare Shield
Must be discussed with the factory

BEAM ANGLES

High efficiency Reflectors. Field replaceable

IES files available for download: www.hunzalighting.com/download.php

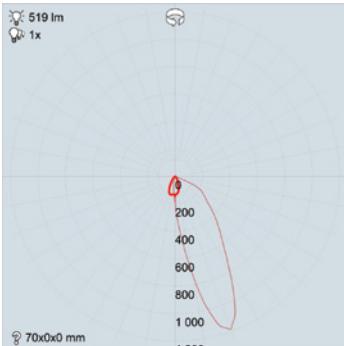

ASYMMETRIC LENS

WIRING GUIDE

available for download: www.hunzalighting.com/download.php

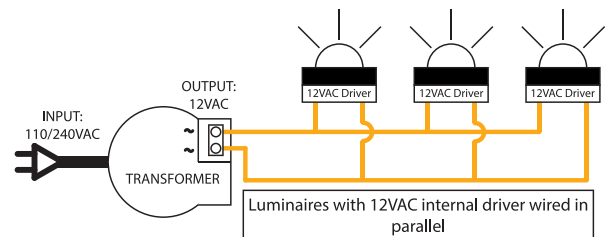
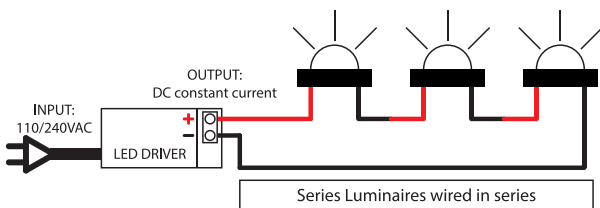

Diagrams are a guide only, wire colours and polarity may change depending on fixture and country