

Floor Lite & Floor Lite Louvre

Cat. No. FLSP

Cat. No. FLLU

Cat. No. FLSPGU

Cat. No. FLLUGU



The Floor Lite has an extremely low profile (3mm) and can be walked upon without damaging the luminaire.

There are two flange designs: Spot and Louvre (45 degree angle), supplied with a mounting canister.

A GU10 version of this luminaire is also available for line voltage lamps.



FLLU

Ordering Information

Luminaire Type

FLSP - Floor Lite Spot
 FLLU - Floor Lite Louvre
 FLSPGU - Floor Lite Spot GU10
 FLLUGU - Floor Lite Louvre GU10

Material

COP - Copper
 SS - Stainless Steel

Accessories

CJK150 - Cable Joint Kit
 CANSS - Stainless Steel Canister
 DKCAN - Deck Canister
 LENSSTEPF - Frosted Lens
 HCL - Hex Cell Louvre

Ordering Example: FLSP SS - Floor Lite Spot in Stainless Steel
 FLLUGU COP - Floor Lite Louvre GU10 in Copper
 HCL - Hex Cell Louvre
 (accessories ordered separately)

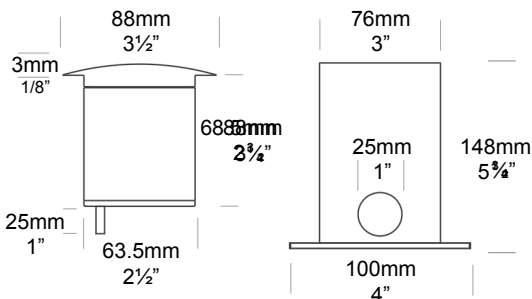

Floor Canister
 (supplied with luminaire)

HUNZA™ PURE OUTDOOR LIGHTING

HUNZA FACTORY 130
 Felton Mathew Ave
 Glen Innes
 Auckland 1072
 New Zealand

Ph: 64-9-528 9471 Fax: 64-9-528 9361
 hunza@hunza.co.nz
 www.hunzalighting.com

INTERNATIONAL CONTACTS:
www.hunzalighting.com/contact.php

Specifications may change without notice.
 Manufactured in New Zealand.
 © 2016 Hunza Holdings Ltd.

Luminaire Construction

CNC machined from one of the following materials

Copper

Body: 63.5mm (2") x 10mm (3/8") copper tube.
End cap: 63.5mm (2") solid copper rod.
Flange: 90mm (3 1/2") solid copper rod.

316 Stainless Steel

Body: 63.5mm (2") x 10mm (3/8") stainless steel tube.
End cap: 63.5mm (2") stainless steel rod.
Flange: 90mm (3 1/2") stainless steel rod.

Mounting

The luminaire is pushed into the canister and is held in by two silicone "O" rings.
CANSS or FLCAN is cast into concrete, brick, tiles, etc.
DKCAN is mounted into wooden decks, wooden frames, etc.

Features

Lens

10mm (3/8") clear tempered shatter resistant glass.

Gasket

Silicone, iron impregnated 220°C (428°F)

Lamp Holders

MR16 & GU10 - 350°C (662°F) ceramic multi contact lamp holder with 250°C (480°F) Teflon cables.

Accessories

Cable Joint Kit (Cat. CJK150). Not approved for USA/Canada.

Stainless Steel Canister (Cat. CANSS).

Deck Canister (Cat. DKCAN).

Frosted Lens (Cat. LENSSTEPF).

Hex Cell Louvre (Cat. HCL).

Standards

EN60598, IP67, UL1838, 

Luminaire Weight

Copper - 1.200kg (2lb 10oz)
Stainless Steel - 0.995kg (2lb 3oz)

Power Supply

Hunza Inground or Wall Mount Transformer: not included.

USA and Canada

Hunza Wall Mount Transformer: not included.

Lamp Options

MR16 - 20, 35 or 50 watt lamp max.
GU10 - 10, 25 or 35 watt lamp max.

USA and Canada

MR16 - 20, 35 or 50 watt lamp max.
GU10 - lamp not supplied.

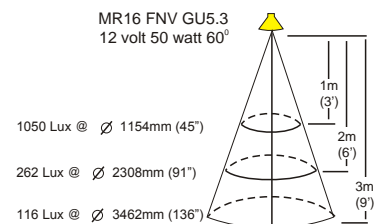
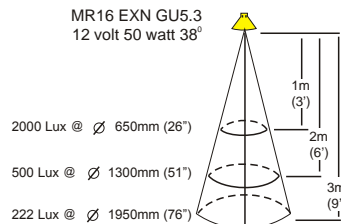
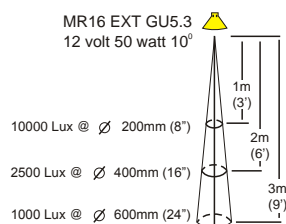
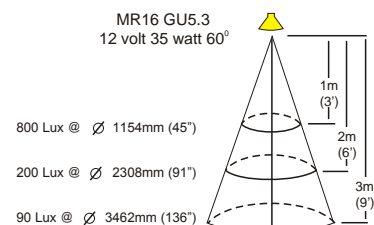
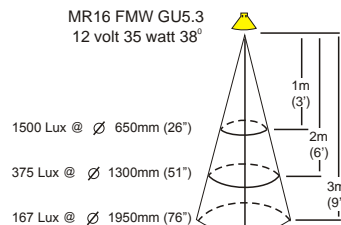
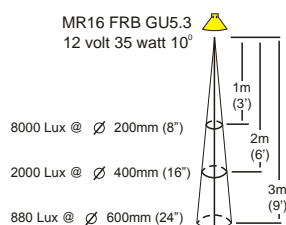
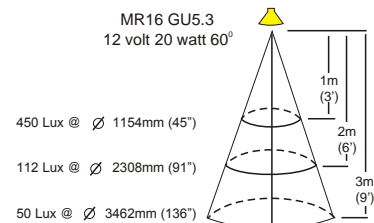
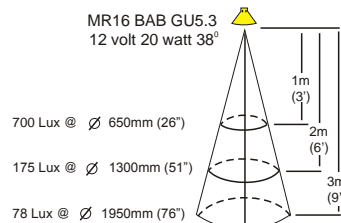
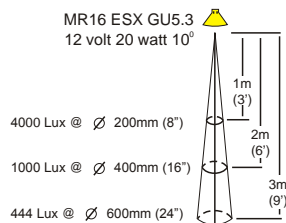

These diagrams refer to the Spot flange only.

HUNZA™ PURE OUTDOOR LIGHTING

HUNZA FACTORY
130 Felton Mathew
Ave Glen Innes
Auckland 1072
New Zealand

Ph: 64-9-528 9471
Fax: 64-9-528 9361
hunza@hunza.co.nz
www.hunzalighting.com

INTERNATIONAL CON TACTS:
www.hunzalighting.com/contact.php

Specifications may change without notice.
Manufactured in New Zealand.
© 2016 Hunza Holdings Ltd.

Ver 1.4