

Pool Lite

PROJECT:
TYPE:
SOURCE:
NOTES:

PURELED SPECIFICATIONS

LED Chip	Cree XHP-50-2 Plug and Play field replaceable LED board
Luminaire Output	600 Lumens @ 1050mA (6 watts), 420 Lumens @ 700mA (4 watts), 240 Lumens @ 350mA (2 watts), delivered from luminaire with unobstructed beam.
Lumens Per Watt	100 Lumens @ 6 watts minimum, delivered from luminaire with unobstructed beam
CRI (3000K)	90+
Colour Temperatures	2700K, 3000K, 4000K
Beam Angles	15, 25, 38, 60
Ingress Protection	IP68
Warranty	Electronics = 5 years Body Stainless Steel = 5 years
Standards	AS/NZS 61046, UL676 (12 volt only)



Pool Lite PVC Canister



Pool Lite PVC Canister 100mm

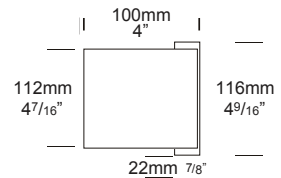
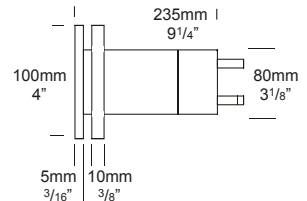
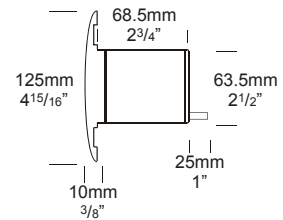

PRODUCT CONFIGURATION

Please fill in appropriate codes into boxes provided

Cat. No. POOL/L

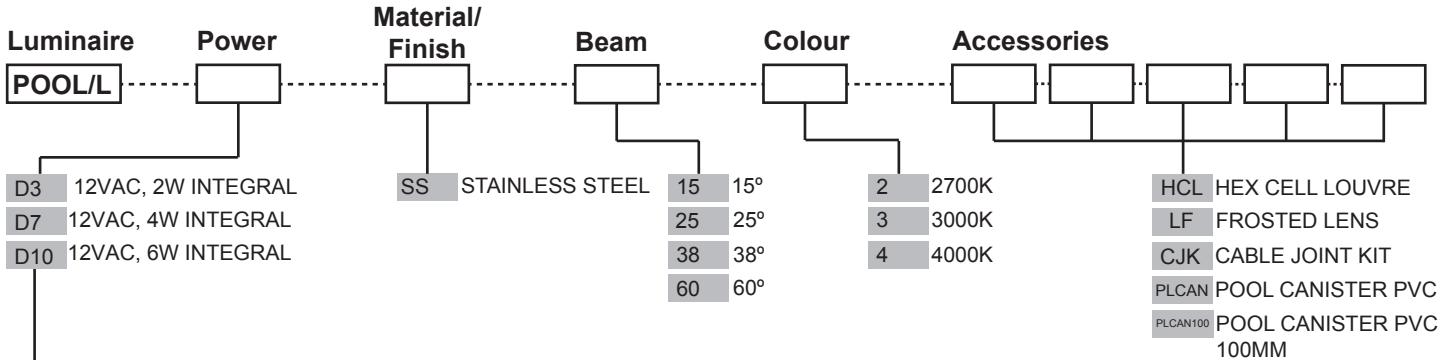

12VAC INTEGRAL DRIVER:
 Hunza integrated plug and play driver (included)
 Input: 9-15VAC.
 Output: 6vdc @ D3=350mA, D7=700mA, D10=1050mA (1050mA limited to ≤ 40°C (104°F) ambient temperature in stainless steel)

OTHER LAMP OPTIONS:
 POOL/H - MR16 Halogen 12V Lamp
 POOL/SL - MR16 LED Retrofit 12V Lamp (lamps vary by market - please refer to supplier for details)

[Click here for halogen specification sheet](#)

[Click here for 240v Remote Power Supply Guidance Charts](#)

[Click here for USA Remote Power Supply Guidance Charts](#)

LUMINAIRE CONSTRUCTION

CNC machined from one of the following metals:

316 Stainless Steel:

Body: 63.5mm (2 1/2") x 9mm (3/8").
End cap: solid 316 stainless steel 63.5 (2 1/2") rod, electro polished to increase corrosion protection by up to 33%.

Canister:

CNC machined from engineering grade PVC with moulded PVC end cap which has 20mm (3/4") conduit entry for electrical connections.

Lens:

10mm (3/8") extra clear, low iron, shatter resistant glass.
Lifetime warranty.

Gaskets:

Silicone, iron impregnated 220°C (428°F).

Mounting:

The PVC mounting canister is suitable for installation into three different types of pool wall. Fibre glass pools, existing concrete pools and new concrete pools.

Cable:

Standard 6 meters
Water resistant rubber

Luminaire Weight:

SS: 1.885kg (4lb 2oz)

WARNING - out of balance pool chemicals may cause the luminaire to corrode at a rapid rate. In salt water an increase in water temperature of 10 degrees will double the corrosion factor. 316 stainless steel is suitable for situations of up to 1000 parts per million of chloride. Where an automatic chlorinator is employed an excess amount of chlorine may be produced. The Hunza Pool Lite is electro polished to increase corrosion protection.

ACCESSORIES

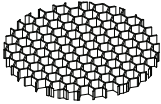

Hex Cell Louvre

BEAM ANGLES

High efficiency PMMA TIR lenses. Field replaceable

IES files available for download: hunzalighting.com/downloads

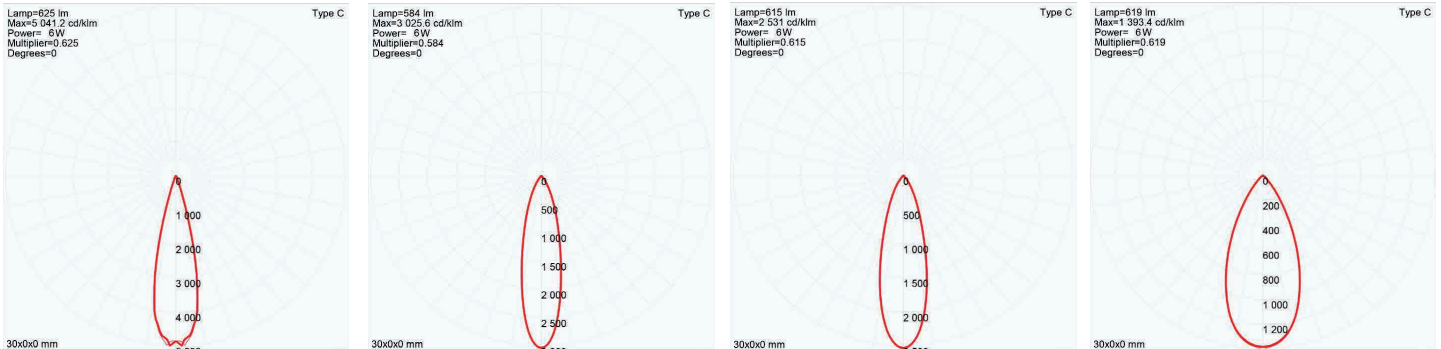

15° FWHM TIR

25° FWHM TIR

38° FWHM TIR

60° FWHM TIR

WIRING GUIDE

Series/remote driver

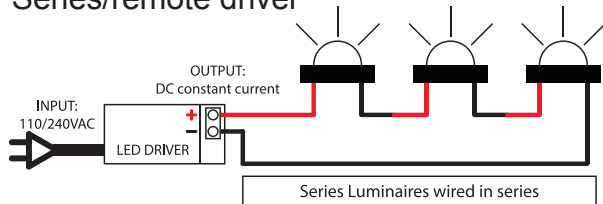

Diagrams are a guide only, wire colours and polarity may change depending on fixture and country

Available for download: hunzalighting.com/downloads

12v integral driver

